

NOTE: 1
 DESIGN CODE:
 N/A

NOTE: 2
 TECHNICAL CLASSIFICATION:
 Article Type: 012-Inspection and Instr.
 Main Group: 12.01. Instrumentation
 Intermediate Group: 12.68.03. Pressur Test
 Sub Group: 12.68.310. Booster

NOTE: 3
 INTERFACE INFORMATION:
 Pressure Rating Bar: N/A
 Material: N/A
 Weight: 175,1 kg
 Volume: 135,93 dm³
 Surface Area: 82772 cm²
 Hydraulic: N/A
 Mechanical: N/A
 Electrical: N/A
 Com. & Protocol: N/A

NOTE: 4
 ADDITIONAL INFORMATION:
 50kg Submerged. To be flown by ROV or mounted onto ROV w/brackets.
 Dual redundant double acting intensifiers with one reservoir of 6 liters.0-200 Bar ROV hydraulic input pressure and maximum 30 liters pr. Minute. Output pressure 0-1035 Bar and 5,6 liters pr. minute on each intensifier. High pressure fluid separated from clean ROV fluid. System built in dump valve and manometer on each system. Separate stab and receptacle for both high pressure and low pressure side. Buoyancy rated to 1100 meter

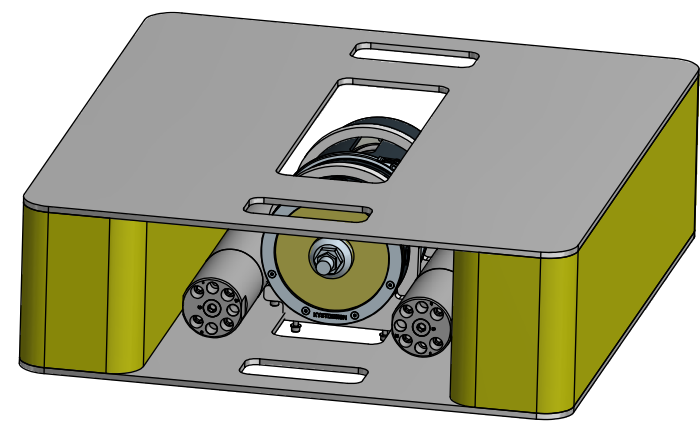
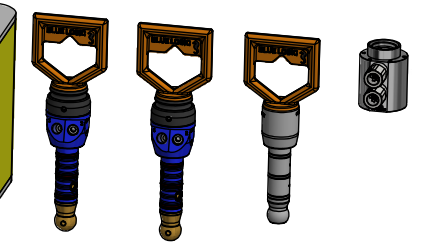
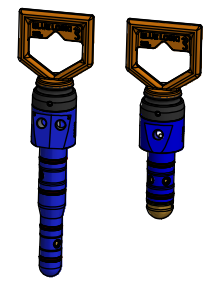
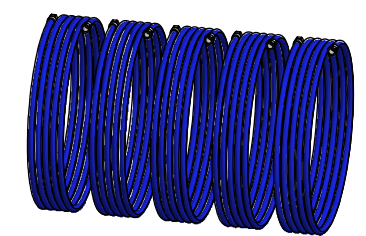

15K Pressure Test Equipment

3K ROV Operation Equipment

FOR INFORMATION ONLY

Rev.	Date	Reason for issue	Revision change	Made	Chk'd	Appr.
02	24.8.2016	2-IFT (Issued For Tender)		WTJ	HNJ	N/A
01	23.8.2016	2-IFT (Issued for Tender)		HNJ	N/A	N/A



Dwg Scale:	NTS
Dwg Proj:	
Dwg Format:	A3

Drawing title:	Full Duplex 15K ROV Booster System	
Drawing number:	BA9000	Rev 02